

February 2024

Land and Water Conservation Fund

Webinar will begin shortly

Application Webinar

Presenters: DeAnn Beck & Allison Dellwo



WASHINGTON STATE
Recreation and
Conservation Office



February 2024

Land and Water Conservation Fund



Application Webinar

Presenters: DeAnn Beck & Allison Dellwo



WASHINGTON STATE
Recreation and Conservation
Funding Board



WELCOME!



Megan Duffy
RCO Director

Recreation and Conservation Funding Board Members

Michael Shiosaki (Board Chair), Citizen

Bob Bugert, Citizen

Shiloh Burgess, Citizen

Kitty Craig, Citizen

Trang Lam, Citizen

Peter Herzog, State Parks and Recreation Commission

Kristen Ohlson-Kiehn, Washington Department of Natural Resources

Amy Windrope, Washington Department of Fish and Wildlife

Agenda

2024 LWCF Application Webinar

- Welcome
- About RCO
- Land and Water Conservation Fund 101
- Funding and Establishing Eligibility
- Federal Readiness Requirements
- Additional Considerations and Application Tips
- Apply Using PRISM Online
- Evaluation Process and Criteria
- Changes for 2024
- Q&A

LWCF GRANTS MANAGERS



DeAnn Beck



Allison Dellwo



Hayley Dalgetty



Henry Smith

Two Grants Sections

Recreation and Conservation Grants

Salmon Recovery

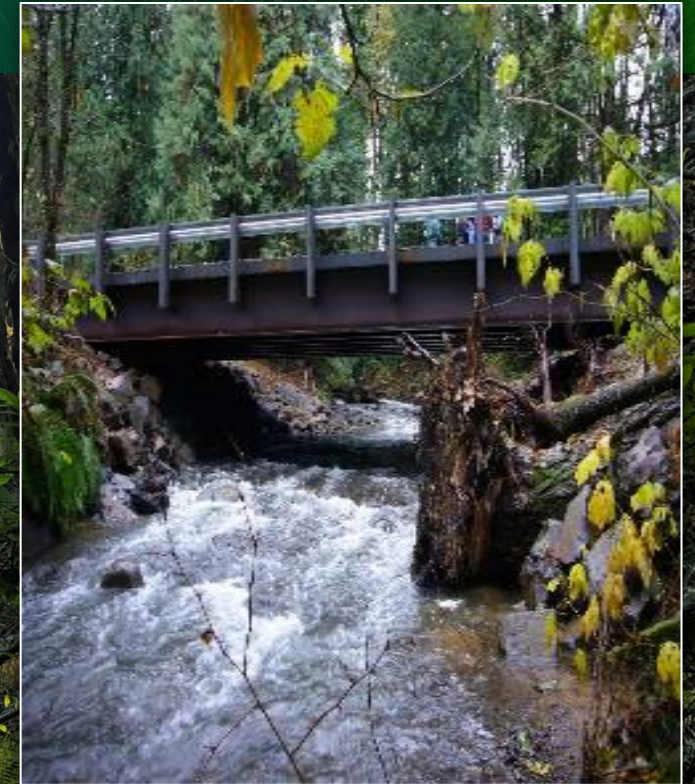

RCO Grant Programs



Recreation and Conservation Funding Board

- Aquatic Lands Enhancement Account (ALEA)
- Boating Facilities Program (BFP)
- Boating Infrastructure Grant (BIG)
- Firearms and Archery Range Recreation (FARR)
- Land and Water Conservation Fund (LWCF)
- Nonhighway and Off-road Vehicle Activities (NOVA)
- Recreational Trails Program (RTP)
- Washington Wildlife and Recreation Program (WWRP)
- Youth Athletic Facilities (YAF)

Salmon Recovery Funding Board

- Puget Sound Acquisition and Restoration (PSAR)
- Salmon Recovery Funding (SRF)

Recreation and Conservation Office

- Community Forests Program (CFP)
- Community Outdoor Athletic Facilities (COAF)
- No Child Left Inside (NCLI)
- Outdoor Learning Grants (OLG)
- Planning for Recreation Access (PRA)
- Recreation and Conservation Office Recreation Grants (RRG)

RCO Grant Programs



Recreation and Conservation Funding Board

- Aquatic Lands Enhancement Account (ALEA)
- Boating Facilities Program (BFP)
- Boating Infrastructure Grant (BIG)
- Firearms and Archery Range Recreation (FARR)
- Land and Water Conservation Fund (LWCF)
- Nonhighway and Off-road Vehicle Activities (NOVA)
- Recreational Trails Program (RTP)
- Washington Wildlife and Recreation Program (WWRP)
- Youth Athletic Facilities (YAF)

Salmon Recovery Funding Board

- Puget Sound Acquisition and Restoration (PSAR)
- Salmon Recovery Funding (SRF)

Recreation and Conservation Office

- Community Forests Program (CFP)
- Community Outdoor Athletic Facilities (COAF)
- No Child Left Inside (NCLI)
- Outdoor Learning Grants (OLG)
- Planning for Recreation Access (PRA)
- Recreation and Conservation Office Recreation Grants (RRG)



Parks



Trails



Habitat Areas





Working Lands



Water Access



Boating





Acquisition



Development



Combination

Acquisition and Development OR Acquisition and Restoration



Restoration

Land and Water Conservation Fund 101



RCO State Grants – LWCF Federal Grants: What's the Difference?



Land Water Conservation Fund

- Established by Congress in 1965: provides funds to preserve and develop outdoor recreation resources, including parks, trails and wildlife lands
- Administered by the National Park Service
- Permanently funded by The Great American Outdoors Act in 2021



2023 Statewide Comprehensive Outdoor Recreation Plan (SCORP)

FOUR PRIORITIES

PRIORITY 1

Provide meaningful access to outdoor recreation for all

PRIORITY 2

Protect natural and cultural resources while managing increasing demand

PRIORITY 3

Demonstrate the essential nature of parks, natural areas, and recreation infrastructure

PRIORITY 4

Support healthy, adaptable, and connected communities



2023 
RECREATION AND
CONSERVATION PLAN

2023 Statewide Comprehensive Outdoor Recreation Plan (SCORP)

[WA RCO SCORP 2023 \(arcgis.com\)](#)

Survey Results, based upon participation:

1. Non-motorized trails
2. Motorized trails
3. Swimming areas, beaches, pools or splash pads
4. Boating, paddling, wind surfing and kite boarding
5. Snow parks, snowmobile trails, Nordic ski trails or snowshoe trails
6. Camping
7. Cultural activities
8. Hunting, gathering, or fishing
9. Wildlife viewing or bird watching
10. Leisure activities at parks
11. Athletics or physical fitness
12. Outdoor adventure sports



What does LWCF fund?





Land and Water Conservation Fund State and National Programs



State Competition Regular Formula Grants (LWCF State)

- *Pass-thru grants*
- *Statewide Comprehensive Outdoor Recreation Plan (SCORP)*
- States administer the evaluation process
- Projects may be broad in scope and must meet state plan priorities (2023 SCORP)
- Indirect costs allowed
- Grant limit: \$200,000-\$2 million dollars
- State apportionment: \$12 million dollars

Website: [Land and Water Conservation Fund - RCO](#)

National Competition Outdoor Recreation Legacy Partnership (ORLP)

- *Pass-thru grants*
- *Statewide Comprehensive Outdoor Recreation Plan (SCORP)*
- States submit applications to NPS and compete nationally
- Eligibility: must meet urban population and disadvantaged area census requirements
- No indirect costs allowed
- Grant limit: \$300,000-\$15 million dollars
- Congressional appropriation: \$224 million dollars

Website: [Outdoor Recreation Legacy Partnership - RCO](#)

Land and Water Conservation Fund Funding and Establishing Eligibility



Eligible Applicants

- Cities, counties, towns
- Native American tribes
- Qualified special purpose districts (parks, ports, schools, etc.)
- State agencies



Eligible Project Types

- Acquisition
- Development

Grant Limits

- \$200,000 minimum
- \$2,000,000 maximum

Match Requirement

- 50% total project cost



Matching LWCF with Other Grants

- Non-federal source (most cases)
- Identical scope of work
- Possibilities: best fits usually
 - WWRP Local Parks
 - Youth Athletic Facilities
- Ensure all costs are eligible with matching grants
- 10% of total project cost must be non-state, non-federal dollars



Acquisition Projects

- Willing seller/tenants/relocation
- Waiver of retroactivity: NPS and RCO approval before closing
- Three-year future development requirement
- Plan for structures
- Environmental screening
- Title report review
- Federal appraisal process/12-month shelf life
- ➔ • Eligible Acquisition Costs: land value, relocation, environmental and cultural resources studies

Consult
OGM
Early!!!!

Development Projects

- Control and Tenure: fee simple
- Project design
- Environmental screening
- Federal permitting
- Cultural resources
- Title report review
- ➔ • Eligible pre-agreement costs: A&E/design, environmental, cultural resources and permitting

Consult
OGM
Early!!!!

Combination Projects

- Challenging to meet federal readiness requirements
- ➔ • Recommended approach:
 - Phased: apply for an acquisition grant
 - Work to meet readiness requirements
 - Design, cultural resources, environmental and federal permitting are all eligible pre-agreement costs (up to 3 years prior to submitting the grant application)
 - Apply for development funds in a future round

Consult
OGM
Early!!!!

Let's Review: Early Scoping!

- Alignment with LWCF and SCORP priorities
- Understand readiness requirements (budget, construction schedule, other fund sources):
 - ✓ Section 106
 - ✓ NEPA
 - ✓ Federal permits
- How much information do you have about your project and the property upon which it will occur?
- What other activities are underway or anticipated (concurrently or later) that could risk your federal funds or create a future compliance issue?



Federal Readiness Requirements

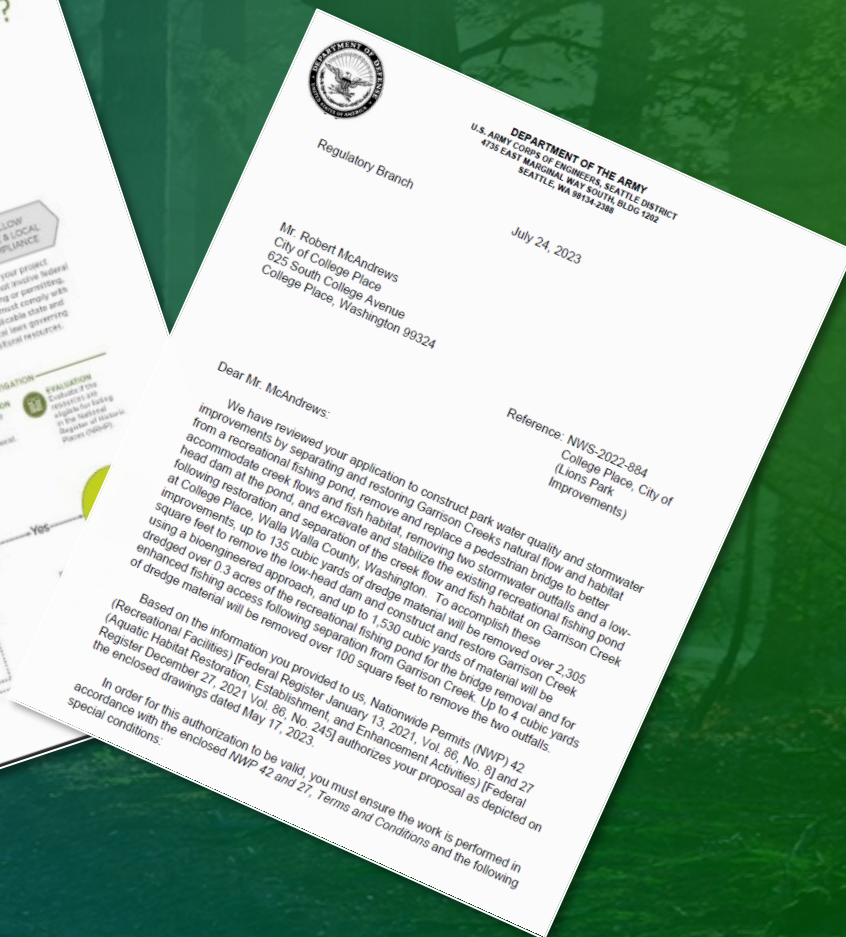
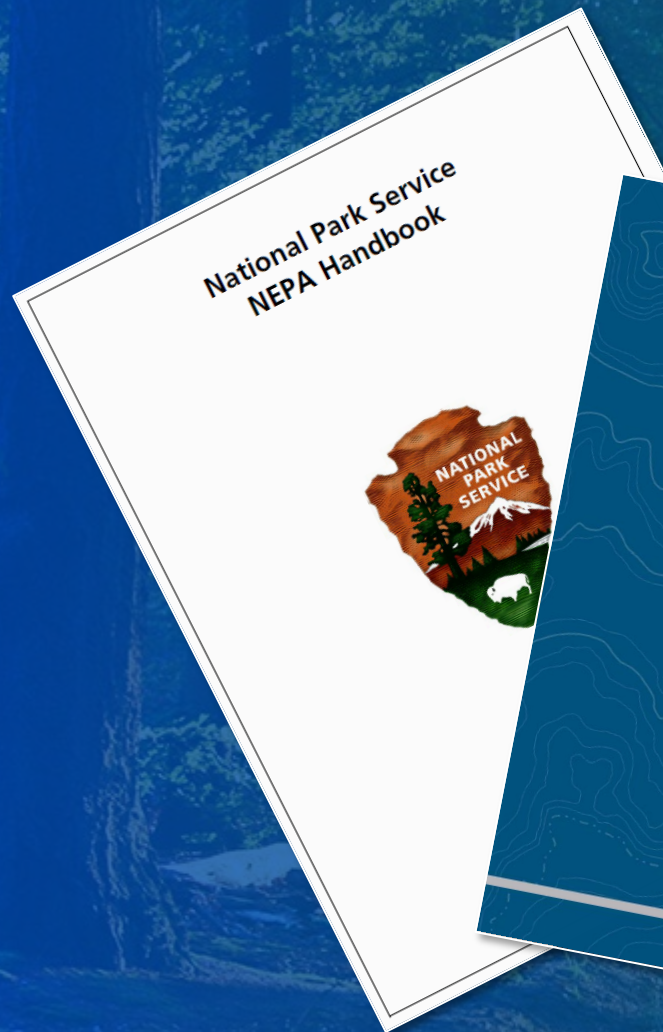

Readiness: What's Different?

- State grant programs – special conditions allowed
- LWCF – no special conditions

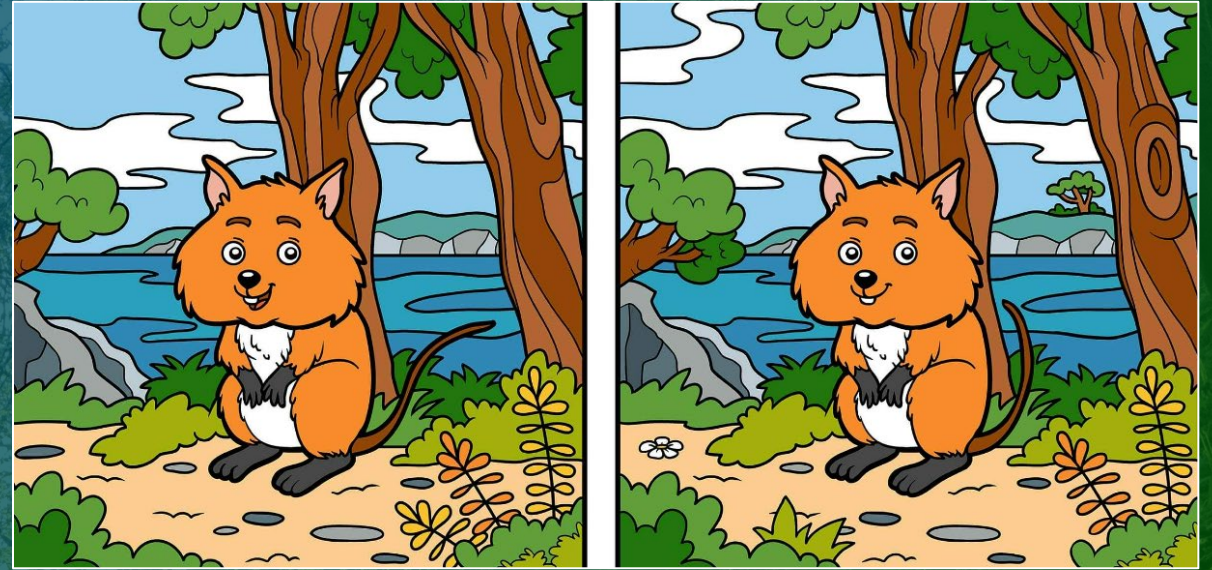

LWCF - that was then ...

- Special conditions allowed time to complete cultural resources and environmental clearances
- Requirement enforcement changed during 2020 application cycle

LWCF - this is now ...

- No more special conditions
- LWCF is a “shovel-ready” program
- February-December timeframe between Sponsor application (PRISM) and NPS application to meet readiness

Section 106: Cultural Resources

National Historic Preservation Act, Section 106:

Consider the effects of actions on historic properties and ensure reasonable action is taken to avoid, minimize or mitigate harm to resources.



Section 106: The Basics

- Required for all LWCF projects
- RCO provides high-level cultural resources review for all applications
- Complete application and developed design assist S106 process
- For projects within funding reach, cultural resources instructions (survey, IDP, etc.) delivered to applicants and consultation is initiated
- 30-day minimum consultation period
- Depending on results of consultation, additional dialogue or work may be required to complete the S106 process
- Starting sooner (with a well-informed design) ensures smoother process

NEPA (Environmental)

National Environmental Policy Act (NEPA)

The NEPA process is intended to help public officials make decisions that are based on understanding of environmental consequences, and take actions to protect, restore and enhance the environment.



NEPA: The Basics

- Required for all LWCF projects
- A well-informed Environmental Resources Survey (ERS) will assist the NEPA process
- Expertise: ensure form authors are qualified to assess data and respond to questions
- Documentation: cite existing studies and reports
- Most projects will qualify for Categorical Exclusion from further environmental review, however, the ERS will be relied upon to support a CE
- NPS may concur with another federal agency's NEPA determination (i.e., USACE)



RCO Grant Number:	Click or tap here to enter text.
Grant Name:	Click or tap here to enter text.

ENVIRONMENTAL RESOURCES SURVEY

Consultation with NPS regarding the NEPA pathway for a proposal should occur prior to the completion of this section. If you have already determined that the proposal will require an EA or EIS, you may go directly to the questions following Tables 1 and 2.

The tables below serve as a record of the environmental resources present at the site, whether the proposed action is likely to have a significantly negative impact on those resources, and whether further information is needed to determine the potential impact. Review the listed resources and identify any resources that may be significantly impacted by the action. The Environmental Resources Survey should be completed with professional input from resource experts and in consultation with relevant local, state, tribal, and federal governments, as appropriate.

Table 1 – For each resource indicate if positive impacts or negative impacts are anticipated to result from the action or if further information is needed to determine the potential impact.

- + indicates positive impacts are anticipated to result from the action
- indicates negative impacts are anticipated to result from the action
- ? indicates further information is needed to determine the potential impact

Site Name: Click or tap here to enter text.

	How will the project affect the following resources?	+	-	?
1	Air quality	<input type="checkbox"/>	<input type="checkbox"/>	<input type="checkbox"/>
2	Circulation and transportation	<input type="checkbox"/>	<input type="checkbox"/>	<input type="checkbox"/>
3	Climate	<input type="checkbox"/>	<input type="checkbox"/>	<input type="checkbox"/>
4	Contamination or hazardous materials even if remediated	<input type="checkbox"/>	<input type="checkbox"/>	<input type="checkbox"/>
5	Endangered species: (listed or proposed threatened or endangered) including associated habitat	<input type="checkbox"/>	<input type="checkbox"/>	<input type="checkbox"/>
6	Environmental justice: minority and low-income populations	<input type="checkbox"/>	<input type="checkbox"/>	<input type="checkbox"/>
7	Geological resources: soils, bedrock, slopes, streambeds, landforms, etc.	<input type="checkbox"/>	<input type="checkbox"/>	<input type="checkbox"/>
8	Historic or cultural resources	<input type="checkbox"/>	<input type="checkbox"/>	<input type="checkbox"/>
9	Invasive species	<input type="checkbox"/>	<input type="checkbox"/>	<input type="checkbox"/>
10	Land use plans or policies from other agencies including tribes	<input type="checkbox"/>	<input type="checkbox"/>	<input type="checkbox"/>
11	Lightscares, especially night sky	<input type="checkbox"/>	<input type="checkbox"/>	<input type="checkbox"/>

Federal Permits

A sponsor of a project that requires any federal permits, including the U.S. Army Corps of Engineers' permit, must provide a copy of the issued permit within sixty days of the Recreation and Conservation Funding Board's approval of the preliminary ranked list of projects or the project will not be funded.

If it has been determined that the project does not need a federal permit, the sponsor must provide documentation of that decision including which federal regulator made this determination. Due to the long lead time for obtaining federal permits, the sponsor must start this process before submitting the grant application. See the Applicant's To Do List.



Pathway to Federal Readiness: Budget, Design, Investigate . . . stat!



Budget

- ✓ Pre-agreement costs eligible 3 years prior to application date:
 - A&E/design
 - Cultural resources
 - Environmental studies/permitting
- ✓ Consider application/award/construction start timeline and estimate costs accordingly



Design

- ✓ Must be far enough along to fully understand the impacts of the project on the landscape to assess environmental and cultural resources effects
- ✓ 30% design level recommended
- ✓ Design and budget for accessibility: must meet or exceed Americans with Disabilities Act Standards

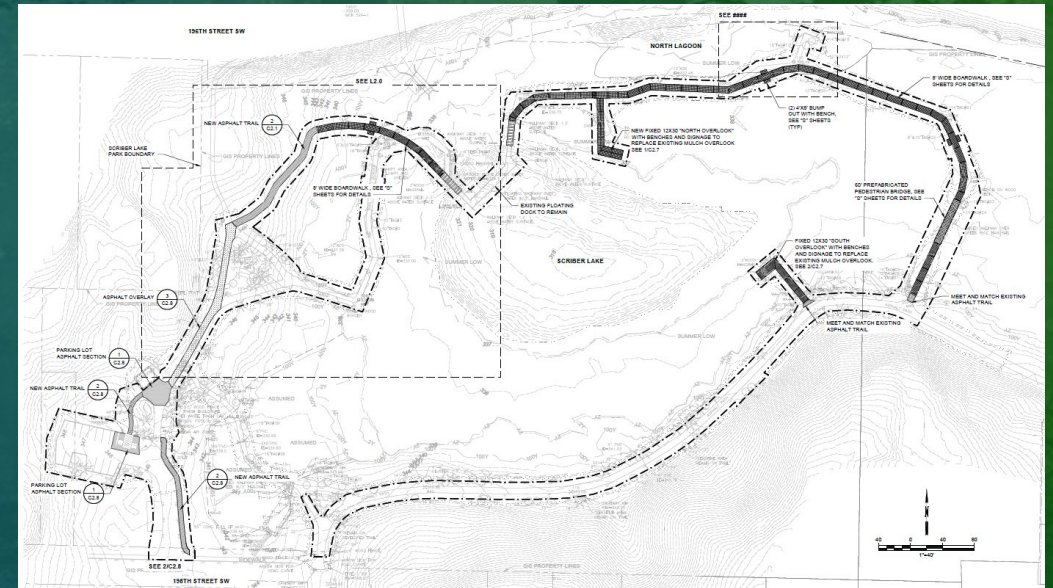

Investigate

- ✓ Complete cultural resources PRISM questions to assist initial RCO guidance and to establish readiness for Section 106 consultation
- ✓ Complete Environmental Resources Survey form to assist initial RCO guidance and to establish readiness for NEPA determination
- ✓ Review title report for entire park to understand existing encumbrances

LWCF Boundary Map

- Places entire park (not just funded area or improvements) under LWCF conversion policy in perpetuity
- Confer early with your OGM
- Disclose existing third-party rights and infrastructure serving outside park.
- Order title report early to inform the boundary map. Important to understand what is going on in entire park, not just the project area.
- RCO and NPS pre-approval to consider rare exclusions of ineligible uses or future footprints.

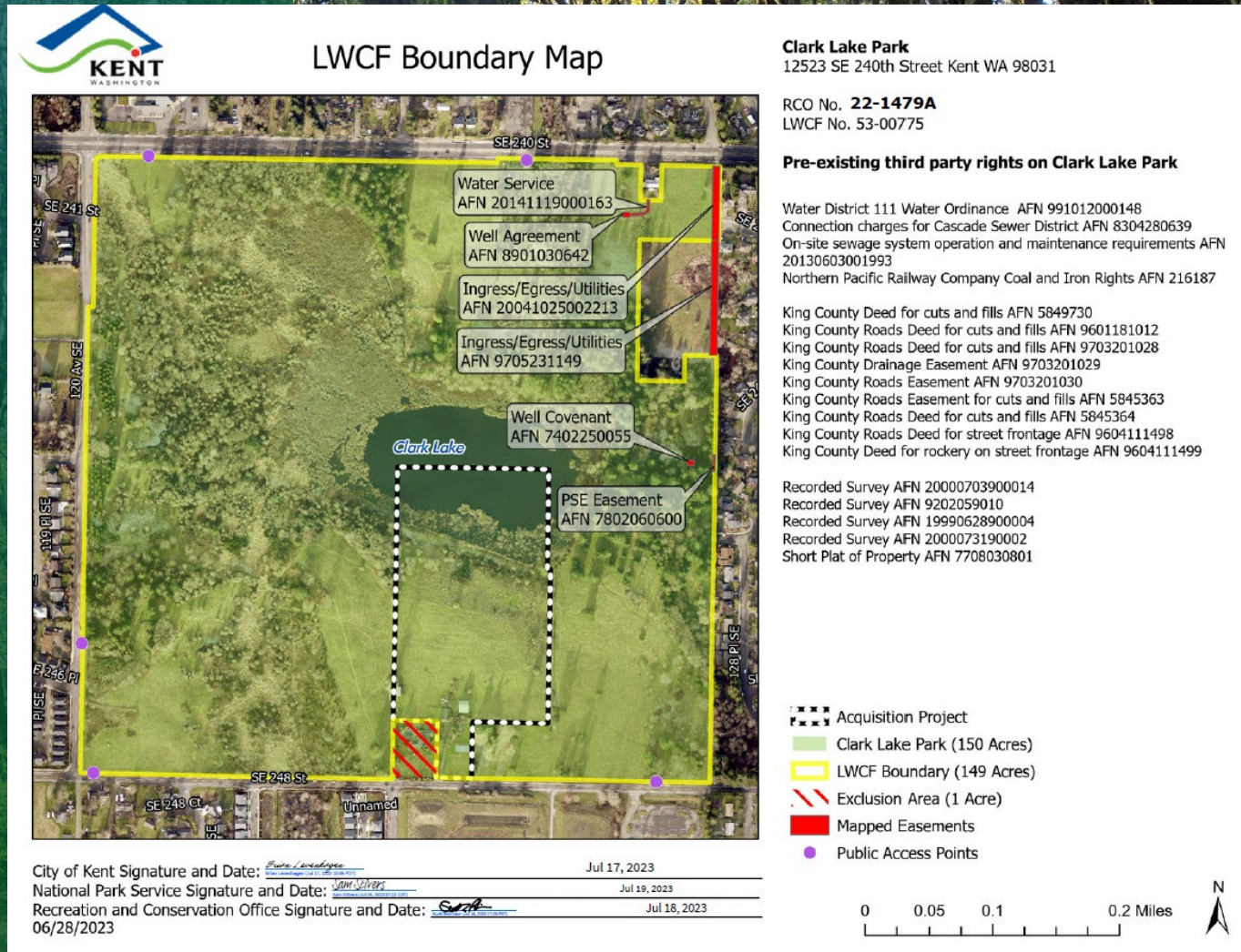

Key Steps

Readiness targets highlighted!



What does a successful LWCF application look like?

- Spokane County Bear Lake Renovation: expanded non-motorized lake access.
- Complex; USACE permit required
- Incurred pre-agreement costs for design, cultural resources & permitting (underway at time of application)
- Environmental Resources Survey and associated material were robust and well-supported
- LWCF Boundary Map included entire park with no exceptions
- Federal agreement issued several months after complete application submitted to NPS



Is it too soon to apply for LWCF funds?

- Design stage is too early (conceptual; APE undetermined)
- Permitting has not been initiated
- No environmental investigations
- Not enough information known to robustly complete an Environmental Resources Survey
- Scope of work not well-defined and subject to significant changes
- Not enough information to commit to an LWCF boundary required for long-term compliance



Key Points

- Meeting readiness requirements by December 2024 is essential before ranked projects within funding reach will be determined actionable and forwarded to NPS:
 - Section 106/NEPA clearances (all projects)
 - Federal permits in place (if required)
- LWCF Boundary map - final:
 - Sponsor, RCO and NPS sign
 - In perpetuity and covers entire park
- Incurring pre-agreement costs necessary to meet readiness requirements





Additional Considerations

Build America, Buy America³⁸

Build America, Buy America Act requires that all iron, steel, manufactured products, and construction materials used for, or incorporated into, a federally funded project are produced in the United States. This includes the purchase of bridges, girders, docks, fencing, drinking fountains, play structures, and more. The procurement preference applies to the following categories of products and materials:

- **All iron and steel.** All manufacturing processes, from the initial melting stage through the application of coatings, must occur in the United States.
- **All manufactured products.** Must be manufactured in the United States and the cost of its domestically mined, produced, or manufactured components must be greater than 55 percent of the total cost of all its components unless another standard applies under law or regulation.
- **All construction materials.** All manufacturing processes for the construction material must occur in the United States.

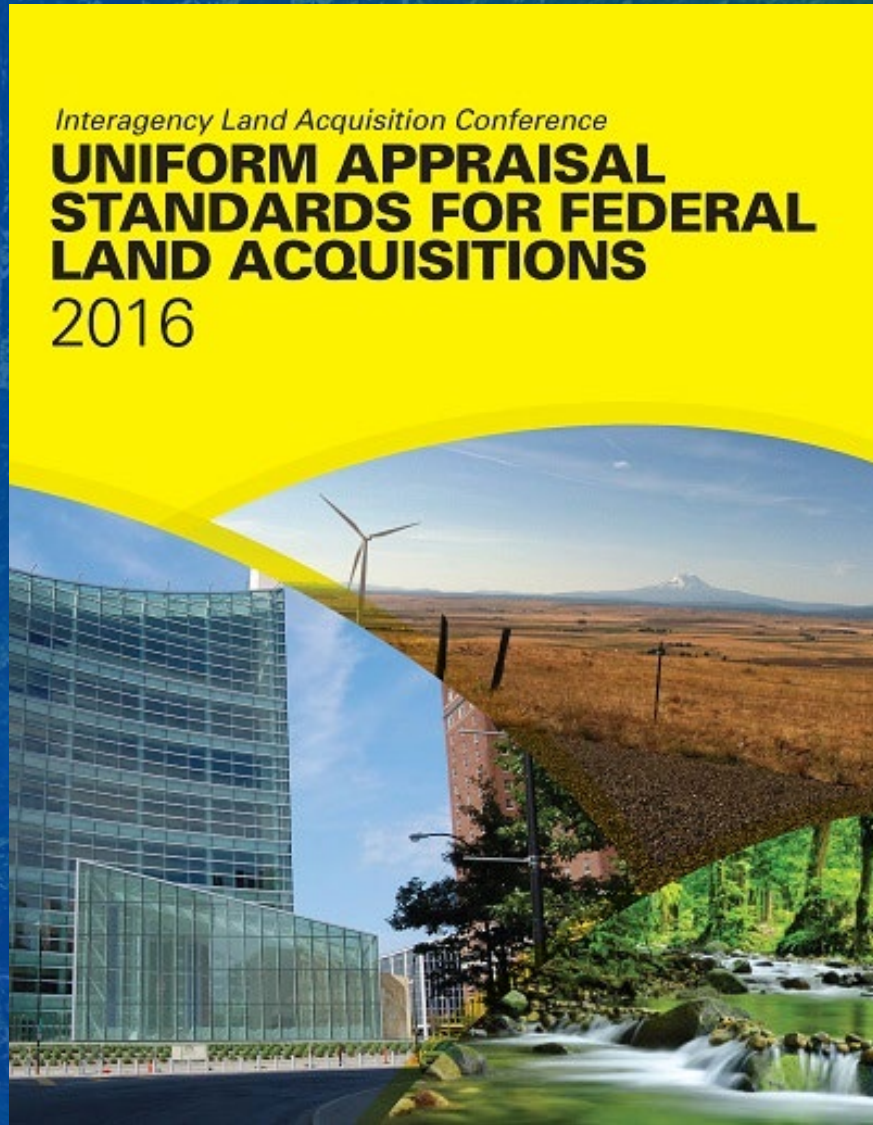

From RCO Manual 3: Acquisition Projects, Section 5: Appraisal Requirements

Projects with Federal Money

For projects funded with the **Land and Water Conservation Fund**, the project sponsor must instruct the appraiser and review appraiser to use the standards set forth in the *Uniform Appraisal Standards for Federal Land Acquisitions* (UASFLA).

In addition, projects in the Land and Water Conservation Fund must follow special appraisal instructions (see *Manual 15: Land and Water Conservation Fund*). When an acquisition project will receive funding from both state and federal sources, the project sponsor may apply the federal standards to the entire project.

Application Tips

Communicate
with your Grants
Manager early!

Confirm
eligibility before
submission

Note key dates
on
Application
To-Do List

Read manuals
and all resources
closely

Scope and
budget to meet
readiness
requirements

Initiate permitting,
cultural resources
and environmental
assessments

Get familiar with
the RCO website

Start your
application now

Prepare for your
presentation



Getting ready to apply

Review RCO policy materials

- Manual 3: Acquisitions Projects
- Manual 4: Development Projects
- Manual 7: Long-Term Obligations
- Manual 8: Reimbursements
- Manual 15: Land and Water Conservation Fund

Eligibility

- Legal Opinion: first-time applicants
- Comprehensive Plan Due March 1, 2024
- Authorizing Resolution: establish authority to proceed with application and enter agreement with RCO



Requirements to apply:

1. For LWCF, applicants must have a current comprehensive outdoor recreation plan on file with RCO to apply.

Plans are due to RCO by March 1!

Plans are effective for six years.

RCO website has planning requirements and lists of applicants with plans on file.

Contact Nick Norton at nicholas.norton@rco.wa.gov.

2. ALL first-time applicants need to submit a legal opinion to RCO by the technical completion deadline.

Authorizing Resolution

Secure appropriate authorization

- Who prepares and submits the grant application?
- Who signs the grant agreement, if awarded?
- Who sign amendments to the agreement, if applicable?
- Who submits bills or reimbursement requests?



Applicant Resolution/Authorization

Organization Name (sponsor) _____

Resolution No. or Document Name _____

Project(s) Number(s), and Name(s) _____

This resolution/authorization authorizes the person(s) identified below (in Section 2) to act as the authorized representative/agent on behalf of our organization and to legally bind our organization with respect to the above Project(s) for which we seek grant funding assistance managed through the Recreation and Conservation Office (Office).

WHEREAS, grant assistance is requested by our organization to aid in financing the cost of the Project(s) referenced above;

NOW, THEREFORE, BE IT RESOLVED that:

1. Our organization has applied for or intends to apply for funding assistance managed by the Office for the above "Project(s)."
2. Our organization authorizes the following persons or persons holding specified titles/positions (and subsequent holders of those titles/positions) to execute the following documents binding our organization on the above projects:

Grant Document	Name of Signatory or Title of Person Authorized to Sign
Grant application (submission thereof)	
Project contact (day-to-day administering of the grant and communicating with the RCO)	
RCO Grant Agreement (Agreement)	
Agreement amendments	
Authorizing property and real estate documents (Notice of Grant, Deed of Right or Assignment of Rights if applicable). These are items that are typical recorded on the property with the county.	

The above persons are considered an "authorized representative(s)/agent(s)" for purposes of the documents indicated. Our organization shall comply with a request from the RCO to provide documentation of persons who may be authorized to execute documents related to the grant.



Grants

What We Do

Get Involved

About Us

Contact Us

Investing in Washington's Great Outdoors

Recreation >>

Conservation >>

Salmon And Orca Recovery >>

Invasive Species >>

FIND A GRANT



Grant Details >

[Grants Overview](#)[Find a Grant](#)[Apply for a Grant](#)[Grant Requirements](#)[Protecting Cultural Resources](#)[Grant Manuals](#)[Evaluation](#)[Post Award Information](#)[Contact a Grants Manager](#)

Grant Programs >

[ALEA](#)[FARR](#)[NOVA - Education](#)[WCRI](#)[BAFBRB](#)[FFFPP](#)[NOVA - Trails](#)[WWRP - Farmland](#)[BFP](#)[LPM](#)[OLG](#)[WWRP - Forestland](#)[BIG](#)[LWCF](#)[PRA](#)[WWRP - Habitat](#)[CFP](#)[LWCF-ORLP](#)[RTP](#)[WWRP - Recreation](#)[COAF](#)[NCLI](#)[SALMON - PSAR](#)[YAF](#)[ESRP](#)[START YOUR APPLICATION](#)[Learn How To Apply >>](#)[CONTACT STAFF](#)[APPLY NOW](#)



[Grants](#)

[What We Do](#)

[Get Involved](#)

[About Us](#)

[Contact Us](#)

LWCF

Land and Water Conservation Fund

FUNDING

\$14 million

[Details](#)

GRANT LIMIT

\$2,000,000

[Details](#)

MATCH REQUIREMENT

50%

[Details](#)

[START YOUR APPLICATION](#)

[Learn How To Apply >>](#)

[CONTACT STAFF](#)

[APPLY NOW](#)

<https://rco.wa.gov>

56



Congress created the fund in 1965 with the passage of the Land and Water Conservation Fund Act, which authorizes the Secretary of the Interior to provide financial assistance to states for the acquisition and development of public outdoor recreation areas. All communities may compete for funding in this program.

Grant Application Schedule

Item	Date
Applicant Webinar, Applications Open <i>Register for Webinar</i>	February 14, 2024
Plan Due <i>A comprehensive plan is required to be eligible for a grant.</i>	March 1, 2024
Application Due	May 1, 2024
Technical Review	June 5, 2024 - June 7, 2024 <i>Estimate</i>
Technical Completion Deadline	July 18, 2024
Project Evaluation	August 21, 2024 - August 23, 2024 <i>Estimate</i>
Board Approves Preliminary Ranked Lists	October 29, 2024 - October 30, 2024

Grant Award History

Most recent grants and evaluation results, listed by the application year.

2022

2020

2018

GRANT MANUAL

Grant Forms

- Applicant Authorization Resolution
- Application and Revision (A&R) Form
- Assurances for Construction Programs (SF-424D)
- Certification of Applicant Match Form
- Department of Natural Resources Scope of Work Acknowledgement Form
- Electronic Signature Authorization Form
- Fiscal Data Collection Sheet
- Manual 3: Acquisition Projects
- Manual 4: Development Projects

LWCF Resources

- Applicant's To-Do List
- Environmental Resources Survey Form
- Fact Sheet

General Resources

- 2022 Application Webinar Presentation
- Tips for Developing a PowerPoint Presentation for Grant Applicants

Board Approves Preliminary Ranked Lists

October 29, 2024 - October 30, 2024

Grant Award History

Most recent grants and evaluation results, listed by the application year.

 2022

 2020

 2018

Previous Years ▼

 [Fact Sheet](#)

General Resources

 [2022 Application Webinar Presentation](#)

 [Tips for Developing a PowerPoint Presentation for Grant Applicants](#)

[Announcements](#)

[Typical Projects](#)

[Who May Apply?](#)

[Planning Requirement](#)

[Funding](#)

[Grant Limits](#)

[Administrative Costs](#)

[Match Details](#)

Announcements

Changes to evaluation criteria for 2024

- [Register for the April Criteria Changes Webinar](#)
- [Fact sheet](#)



Resources

[Outdoor Recreation Inventory](#): The 2023 Outdoor Recreation Inventory map and dashboard includes information on more than 23,000 outdoor recreation areas, facilities, trails, and water access sites. It is used to understand the quantity and distribution of key outdoor recreation opportunities. The dashboard also includes a service area analysis for outdoor recreation opportunities, such as accessing a local park or trail.

Typical Projects

Grants Awarded

Land and Water Conservation Fund

2023-2025

Note: All grant awards have not been made yet. This list will be updated as the federal government awards funding.

Rank	Score	Project Number and Type ¹	Grant Applicant	Project Name	Grant Request	Applicant Match	Total	Grant Awarded
1	46.11	22-1479 A	Kent	Ruth Property at Clark Lake Park	\$2,000,000	\$4,750,000	\$6,750,000	\$2,000,000
2	45.22	22-1264 D	Lynnwood	Scriber Lake Park Boardwalk Trail	\$2,000,000	\$2,367,058	\$4,367,058	\$2,000,000
3	43.44	22-1258 D	Seattle	Little Brook Park Improvements	\$800,000	\$1,000,000	\$1,800,000	
4	43.33	22-1299 D	Olympia	Yelm Highway Community Park Phase 1	\$2,000,000	\$11,500,438	\$13,500,438	
5	43.22	22-1473 D	Spokane	Make Beacon Hill Public Phase 2	\$1,060,000	\$1,074,000	\$2,134,000	
5	43.22	22-1583 D	Spokane	Riverfront Park South Suspension Bridge Renovation	\$1,400,000	\$1,414,500	\$2,814,500	\$1,400,000
7	42.67	22-1724 D	Lakewood	Wards Lake Park Phase 2	\$1,250,000	\$1,250,000	\$2,500,000	
8	42.06	22-1430 D	Spokane County	Bear Lake Regional Park Phase 1 Renovation	\$1,383,323	\$1,585,000	\$2,968,323	\$1,383,323
9	42	22-1253 D	Seattle	Rainier Beach Playfield Skatepark	\$1,000,000	\$1,500,000	\$2,500,000	
10	41.83	22-1644 D	Othello	Kiwanis Park Spray Park, Lighting, and Walking Trails	\$600,000	\$658,120	\$1,258,120	
11	41.33	22-1694 D	Spokane Valley	Greenacres Park Phase 2	\$1,000,000	\$1,061,761	\$2,061,761	
12	40.67	22-1703 D	Fife	Wedge Park Revitalization	\$418,822	\$418,822	\$837,644	
13	40.39	22-1310 D	Pierce County	Orangetate Park Phase 1	\$1,000,000	\$5,837,000	\$6,837,000	
14	39.06	22-1399 D	Snohomish County	Kayak Point Waterfront Improvements Phase 2	\$2,000,000	\$3,569,112	\$5,569,112	
15	39	22-1608 D	Lacey	Greg Cuoio Park	\$2,000,000	\$3,529,819	\$5,529,819	
16	38.89	22-1590 C	Port of Allyn	Sweetwater Creek Waterwheel Park	\$828,075	\$1,099,077	\$1,927,152	
17	38.78	22-1392 D	Sumner	Seibenthaler Park Phase 1 Spray Park	\$762,500	\$762,500	\$1,525,000	
18	38.56	22-1488 D	Colfax	Pool Update	\$1,530,000	\$1,597,500	\$3,127,500	
19	36.56	22-1434 D	Monroe	North Hill Area Park	\$2,000,000	\$3,013,500	\$5,013,500	
20	36.17	22-1751 D	Walla Walla	Pioneer Park Inclusive Playground	\$1,250,000	\$1,250,000	\$2,500,000	
21	36.06	22-1526 D	La Center	Holley Park Playground	\$383,036	\$383,036	\$766,072	
22	36	22-1262 D	Seattle	Soundview Playfield Renovation	\$2,000,000	\$2,000,000	\$4,000,000	

Project Search

Choose Search Criteria

1 - Click criteria links below:

[Organization](#)
[Geographic Area](#)
[Theme or Fund Source](#)
[Project Status](#)
[Project Type](#)
[Project Number](#)
[Project Name](#)
[Keyword](#)
[Fiscal Year](#)

Selected Criteria

[All organizations](#)
[All areas](#)
[All themes and fund sources](#)
[All statuses](#)
[All types](#)
[All project numbers](#)
[All names](#)
[All words](#)
[All fiscal years](#)

2 - Select list or chart format:

Project Category Charts ▼

3 - Click Search to see results:

[Search](#) [Clear Criteria](#)



Number of worksites: 0

Search Results

Source: PRISM Database

Data as of 2/5/2024

Project Search

Choose Search Criteria

1 - Click criteria links below:

Organization
Geographic Area
Theme or Fund Source
Project Status
Project Type
Project Number
Project Name
Keyword
Fiscal Year

Selected Criteria

All organizations
All areas
WWRP - Local Parks
In Progress
All types
All project numbers
All names
skate
All fiscal years

2 - Select list or chart format:

Project Listing

3 - Click Search to see results:

Search

Clear Criteria























Number of worksites: 10

Search Results

4 - Click icon to display Project Snapshot

10 total projects

Export

Number	Type	Project Sponsor	Project Name	Status	End Date	Fund Source	Agency Funding	Sponsor Match	Total with Match	Zoom To
22-1540	D	Cathlamet Town of	 Cathlamet Skate Park	In Progress	06/30/2025	WWRP - Local Parks	\$95,404	\$10,601	\$106,005	
22-1413	D	Westport City of	 Westport Skatepark and Pumptrack	In Progress	12/31/2025	WWRP - Local Parks	\$500,000	\$243,508	\$743,508	
22-1255	D	Seattle Parks & Rec Dept	 Rainier Beach Playfield Skatepark	In Progress		WWRP - Local Parks	\$500,000	\$2,000,000	\$2,500,000	
20-1802	D	Ferndale City of	 Metalworks Skate Park	In Progress	12/31/2024	WWRP - Local Parks	\$480,000	\$81,850	\$561,850	
20-1712	D	Omak City of	 Omak Eastside Park Skatepark Upgrade	In Progress	12/31/2024	YAF - Large	\$418,465	\$0	\$418,465	
20-1648	D	Poulsbo City of	 Play for All at Raab Park	In Progress	06/30/2024	Land and Water Conservation	\$749,824	\$0	\$749,824	
20-1645	D	Puyallup Parks & Recreation	 Van Lierop Park Playground	In Progress	06/30/2024	WWRP - Local Parks	\$500,000	\$299,857	\$799,857	
20-1632	AD	Republic City of	 Republic Skatepark	In Progress	12/30/2024	WWRP - Local Parks	\$348,600	\$45,000	\$393,600	
18-1666	D	Ferry County of	 Hesse Rec Park: Phase 1	In Progress	12/31/2024	WWRP - Local Parks	\$108,900	\$12,100	\$121,000	
16-1884	AD	South Whidbey Parks & Rec Dist	 South Whidbey Campground Phase 1	In Progress	12/31/2024	WWRP - Local Parks	\$414,647	\$414,647	\$829,294	
Total							\$4,115,840	\$3,107,563	\$7,223,403	



Rainier Beach Playfield Skatepark

[Collapse All](#)

Project Details



Seattle Parks & Rec Dept: Rainier Beach Playfield Skatepark (#22-1255)
Attachment #504346, site.jpg

Project Status: Board Funded since 06/28/2023

Project Type: Development

Project Sponsor: [Seattle Parks & Recreation Department](#)

Funding Board: [Recreation and Conservation Funding Board](#)

Funding

WWRP - Local Parks:	\$500,000	
Total RCO Grant:	\$500,000	(20%)
Sponsor Match:	\$2,000,000	(80%)
Total Agreement:	\$2,500,000	(100%)

Links

[Attachments: 33 files](#)



Project Description

The Rainier Beach Skateboard Park project is a development project in the Rainier Beach neighborhood in Southeast Seattle. Rainier Beach is one of the most demographically diverse communities in Seattle and among the most underserved in Park resources. The goal of this application is to fund construction of the project to include demolition, erosion control, grading, installation of green stormwater infrastructure, a skateboard facility, picnic





Apply Using PRISM Online

PRISM Account



- Complete PRISM New User Account Form
- Create a SAW account
- Add a new service to SAW (“PRISM Online”)
- Complete a double sign-on
- Detailed instructions can be found on our [PRISM webpage](#)

**PRISM Online works best using these Internet browsers:
Edge, Chrome, Firefox, or Safari
(Internet Explorer is NOT recommended)**

LWCF

Land and Water Conservation Fund

FUNDING

\$14 million

[Details](#)

GRANT LIMIT

\$2,000,000

[Details](#)

MATCH REQUIREMENT

50%

[Details](#)

START YOUR APPLICATION

[Learn How To Apply >>](#)

CONTACT STAFF

APPLY NOW

Account Set-Up and Applying

About PRISM

PRISM is an online computer system open to the public to apply for RCO grants, review and manage information on funded grants, and produce reports on projects. More detailed information about PRISM components, forms, and training videos is on the RCO [PRISM website](#).

Creating a PRISM Account

To enter an application, an applicant must sign up for a [SecureAccess Washington](#) account and submit a [PRISM account form](#). When using either of these databases for the first time, the applicant must complete a double sign-in.

- Using SecureAccess Washington credentials, login to PRISM.
- When redirected to the SecureAccess login page, enter the SecureAccess credentials.
- When redirected to a one-time PRISM sign-in page, enter the PRISM login credentials.
- The applicant will be directed back to the PRISM home page.

This double sign-in will happen only once. After completing the double sign-in, the applicant will use SecureAccess Washington credentials to log into PRISM.

Beginning the Pre-Application

To begin an application, log into PRISM, select the *+New Application* button and find the *Community Outdoor Athletic Facilities Pre-Application* option in the drop-down menu. Once the pre-application has been started, RCO uses this information to assign an outdoor grants manager to the project. This manager guides the applicant through the process, reviews application materials, helps determine whether the proposal is eligible, and may visit the project site to discuss site-specific details. When working through the PRISM pre-application, be sure to read the guidance on each page closely and save work frequently. A more detailed checklist of the different pre-application sections and required fields is in the [Pre-Application Checklist](#).

Submitting the Pre-Application

The application includes the data entered into PRISM and all attachments. The applicant must submit the application before the deadline. The *Check Application for Errors* button on the *Submit Application* screen will indicate which pages are incomplete. An incomplete application and an application received after the deadline will be rejected unless RCO's director has approved a late submission in advance.

Completing an Application

PRISM
online

HomeMenuSponsor ResourcesStaff ResourcesHelp

TEST

APPLICATION WIZARD

PROJECT DETAILS

Parties

Contacts

Program & Project Type

Worksites & Properties

Worksite Details

QUESTIONS

Project Proposal

Evaluation Criteria

METRICS

Development Metrics

COSTS

Development Cost Estimates

Cost Summary

Attachments

Staff Scores

Submit Application

Grant Manager Comments

Change Log

OPTIONS

Grant Manager Comments Rpt

Project Application Report

Project Factsheet Report

Project Review Comments Rpt

Go to Project:

GO

PROJECT: 24-1045 DEV, UMATILLA SKATE PARK RENOVATION

Sponsor: Umatilla Confederated TribesProgram: COAF Pre-ApplicationStatus: Preapplication

BackCheck Page for ErrorsSaveNext

Complete

PARTIES TO THE AGREEMENT

Application Due Date: 3/13/2024

If your application is approved for funding, the following Sponsors will sign the Grant Agreement and be bound by its terms and conditions.

PRIMARY SPONSOR

Confederated Tribes of the Umatilla Indian Reservation

16144 Timpani Way

StateORZip97801-9467

Vendor #

UBI

Date Org created

Org Notes

Verify the information on file for the organization. Enter any updates to the information in the Org Notes field.

[link to Organization profile](#)

[link to PRISM Organization page](#)

☐ Org data updated

SECONDARY SPONSORS

+ Add Sponsor

No records to display

MANAGING AGENCY

Recreation and Conservation Office

The managing agency is the organization responsible for managing the grant program for which you are... [more](#)



Evaluation

Technical Review and Final Evaluation

Evaluation Criteria Changes for 2024

Significant changes made to:

- Project Introduction
- Need and Need Satisfaction
- Project Scope
- Project Design
- Project Engagement (formerly Project Support)
- Expansion and Renovation

Programs affected:

- ALEA
- **LWCF**
- YAF
- WWRP – Local Parks, Trails, and Water Access

Grant Evaluation Criteria

Aligning statewide priorities and equity goals for 2024 and beyond.

Policy Brief
January 2024

Background

During the past year, Recreation and Conservation Office (RCO) staff worked with the Recreation and Conservation Funding Board to revise grant evaluation criteria in six recreation and conservation focused grant programs. With these revisions, RCO and the board intend to improve opportunities for outdoor recreation and physical activity in communities that have less access to parks and open space. RCO also aims to distribute grants more equitably by providing greater opportunities for communities with less capacity and fewer financial resources.

Programs Affected

Aquatic Lands Enhancement Account (ALEA)
Land and Water Conservation Fund (LWCF)
Youth Athletic Facilities (YAF)
Washington Wildlife and Recreation Program (WWRP)

- Local Parks
- Trails
- Water Access

What Changed?

Four criteria commonly used in all six programs were revised: Project Need, Project Scope, Project Design, and Project Engagement.

A new unscored “Project Introduction” was added, while the “Expansion or Renovation” criterion was eliminated from WWRP Local Parks and Water Access.

Applicants no longer need to copy socioeconomic and health data from the application data tool to paste into their project presentations.



Project Need: Statewide Priorities

A data-driven needs assessment.

Project Need consists of two parts: one scored by RCO, and another scored by the advisory committees. The advisory committees will score answers to narrative questions.

The RCO scores are data-driven and reflect statewide priorities in the 2023 Recreation and Conservation Plan and recommendations in RCO's grant program equity review. Points are awarded based on the project location and rankings for **social vulnerability**, **poor health outcomes** from the Department of Health's Washington Tracking Network. Points also are awarded for **green space availability**, based on a spatial analysis from RCO's equity review.



Click or scan for
more details

Questions? Contact an Outdoor Grants Manager.

[rco.wa.gov/recreation-and-conservation-office-grants/
contact-a-grants-manager/](https://rco.wa.gov/recreation-and-conservation-office-grants/contact-a-grants-manager/)



Summary of Criteria

Criteria		Project Type	Maximum Points	Priority
Unscored				
0	Project Introduction	All Project Types	0 Points	Board Priority
Scored by the Advisory Committee				
1	Need–Local Priorities	All Project Types	25 Points	Recreation and Conservation Plan
2	Project Scope	All Project Types	20 Points	Recreation and Conservation Plan
3	Immediacy of Threat and Viability	Acquisition	20 Points	Board Priority
		Combination	5 Points	
4	Project Design	Development Projects	15 Points	Recreation and Conservation Plan
		Combination Projects	10 Points	
5	Project Engagement	All Project Types	20 Points	Board Priority
6	Sustainability	Development and Combination	5 Points	Recreation and Conservation Plan
7	Cost Efficiencies	All Project Types	5 Points	Board Priority
Scored by RCO				
8	Need–Statewide Priorities	All projects	9 Points	Recreation and Conservation Plan
9	Proximity to People	All projects	0.5 Point	State Law
10	County Population Density	All projects	0.5 Point	State Law
11	Applicant Compliance	All projects	0 Points	National Park Service Priority
Total Points Possible:			100 Points	

Evaluation Criteria

Section 4 of the
LWCF grant manual

Make sure you
reference the NEW
2024 manual

Ready, Set, Go

Implementation

- Execute an RCO grant agreement, after federal agreement is issued to RCO
- Comply with milestones in the agreement
- Secure an RCO Notice to Proceed before starting work
- Complete project in a timely manner

Billing, progress reports, and records

- RCO pays on a reimbursement basis only
- Sponsors must submit a bill at least annually
- Sponsors must submit progress reports
- Sponsors must keep meticulous records
- Sponsors must notify RCO of any anticipated changes to the scope of work or timeline

Project
Implementation

Accounting



Long-Term Compliance

What are the ongoing responsibilities?

- Review Manual 7: Long-Term Obligations and Manual 15: Land and Water Conservation Fund
- Inspections: final and compliance
- Project changes: name change, facility change, etc.
- Maintenance: sponsor's responsibility
- Land acquired for future development: three years
- Open to the public: nondiscrimination laws
- Income: requirements for income use
- Acknowledgement: signs, publicity, press releases, etc.
- Subject to LWCF Boundary Map, conversion policy
- If something changes – contact RCO to discuss options.

Long-Term
Compliance



Questions?



DeAnn Beck, LWCF Lead
Senior Outdoor Grants Manager
deann.beck@rco.wa.gov



Allison Dellwo
Outdoor Grants Manager
allison.dellwo@rco.wa.gov



Hayley Dalgetty
Outdoor Grants Manager
hayley.dalgetty@rco.wa.gov



Henry Smith
Outdoor Grants Manager
henry.smith@rco.wa.gov